



Delaware

2022 Design Awards Program
A Celebration of Architecture

AIA Delaware 2022 Design Awards Program

AIA Delaware is committed to excellence in architecture and to celebrating outstanding works of architecture through its biennial Design Awards Program.

The purpose of the program is to recognize and honor excellence in architectural design by licensed architects and to honor the clients and project teams who work with them to create and enhance our built environment.

By focusing attention on a broad range of exemplary activity in the profession, the general quality of architecture practice is elevated and a standard of excellence is established against which all architects can measure their own performance. The program helps to promote public awareness and appreciation of the breadth and value of architecture and architectural practice and to promote the work of our AIA Delaware members.

Award winners will be announced at the Design Awards Celebration, a celebration of design and construction in Delaware, the centerpiece of AIA Delaware's 2022 Design Awards Program, on Thursday, January 19, 2023 in Middletown, Delaware.

About AIA

Founded in 1857, AIA consistently works to create more valuable, healthy, secure, and sustainable buildings, neighborhoods, and communities. Through more than 200 international, state and local chapters, AIA advocates for public policies that promote economic vitality and public wellbeing.

AIA provides members with tools and resources to assist them in their careers and business as well as engaging civic and government leaders and the public to find solutions to pressing issues facing our communities, institutions, nation, and world. Members adhere to a code of ethics and conduct to ensure the highest professional standards.

Eligibility

Project eligibility is dependent on the status of the submitting architect or emerging professional, as follows:

- Any licensed architect who is a member, assigned or unassigned, of AIA Delaware is invited to submit any residential, non-residential or historic preservation project completed, or any unbuilt project initiated, after January 1, 2017.
- Any licensed architect who is a member of another American Institute of Architects component or who is not a member of the Institute is invited to submit any residential, non-residential or historic preservation project located in Delaware and completed after January 1, 2017, or any unbuilt project located in Delaware and initiated after January 1, 2017.
- Any assigned member, or members, of AIA Delaware, including Emerging Professionals (professionals who have completed their academic studies up to the point of licensure or up to 10 years after completion of their academic studies) are invited to submit solutions for tomorrow in the Envision the Future category.

Completed shall be understood to mean “substantially completed” as defined in standard AIA Contract Documents governing design and construction.

Submission Categories

Submission Categories are used only as a means of assisting the jury in reviewing entries with other projects of similar type. Eligible projects, regardless of scope, size, scale, budget, style or building type, may be submitted for award or citation consideration in one Submission Category. Projects will be evaluated on how successfully they have met their individual requirements and on their own merit, not in comparison with any other project.

The AIA Delaware Board of Directors formally adopted the AIA Framework for Design Excellence as criteria for its Design Awards Program. The Framework represents the defining principles of good design in the 21st century and seeks to inform progress toward a zero carbon, equitable, resilient, and healthy built environment. Each submission must describe how the project design achieved outcomes of at least two of the 10 principles in the Framework.

Residential

Single/dual family residential structures, including entirely new construction, additions, restorations, renovations and interiors.

Non-Residential

Entirely new construction, additions, restorations, renovations and interiors for all building types except single/dual family residential. Includes institutional architecture (structures for education, religion and government), commercial architecture (structures for commerce, such as office, retail, multi-family housing and food service) and interiors.

Historic Resources

Pure preservation or restoration, rehabilitation or sympathetic adaptive reuse of existing structures whose overall architectural character is maintained, sympathetic additions to historic structures and replication or reconstruction of damaged or destroyed structures or element thereof.

Unbuilt

Unbuilt projects submitted for award consideration must have been commissioned by a client with the intent to build. Projects submitted in past programs in the Unbuilt category, whether awarded or not, may be submitted as built projects after completion.

Awards

Each project entered is judged for the success with which the project met its individual requirements, with particular emphasis on design excellence. Entries are weighed on individual merit and not in competition with any other. An award winning project demonstrates a high level of design resolution and/or advances the contemporary understanding of design by proposing a new approach to the development of architectural form.

Award with Honor

An Award with Honor, AIA Delaware's highest award, recognizes a project with distinctive character and outstanding achievement.

Award with Merit

An Award with Merit recognizes a project that exceeds minimum expectations as to resiliency, functionality and beauty (firmness, commodity and delight). Submissions should include a brief narrative of why the project is exemplary in any one or more of those areas.

Award

An Award recognizes projects or design elements of notable accomplishment, similar to Honorable Mention.

Sustainability Citation

Recognizes achievements in sustainable design. The jury will confer a Sustainability Citation on any built project it strongly feels met two or more of the AIA Framework for Design Excellence principles, regardless of whether or not the project is bestowed an award.

Jury – AIA Chesapeake Bay Chapter (MD)



Barton Ross, AIA, AICP, LEED AP BD+C – Jury Chair

Firm Name: Barton Ross & Partners, LLC Architects (Chestertown, MD)

Role in Firm: President

President of Barton Ross & Partners, LLC, Barton is an historic architect who has contributed to master plans for the Virginia State Capitol, the United States Capitol and Princeton University.

He has been recognized for contributions to the field of historic preservation by the Society of Architectural Historians, the Vernacular Architecture Forum and the National Park Service. Barton currently serves on the AIA Chesapeake Bay Chapter and AIA Maryland Board of Directors and chairs the state's Historic Resources Committee.

Barton is a graduate of the Virginia Tech School of Architecture + Design and received master's degrees from Columbia University and the University of Pennsylvania.



Chris Elcock, AIA, IIDA, LEED AP – Juror

Firm Name: GWWO Architects (Baltimore, MD)

Role in Firm: Associate Principal

Chris has focused his career on creating impactful and engaging places for people to gather and learn, including visitor centers, education buildings, and performance halls. The new Harriet Tubman Underground Railroad Visitor Center and the new theater at Ocean City Convention Center might be two projects that are known to the chapter.

As a result of his long association with the Department of Natural Resources, Chris serves on Maryland's Coast Smart Council which focuses on developing criteria for the design of state structures that are vulnerable to sea-level rise and flooding.

GWWO Architects is an award-winning design practice dedicated to client service and quality design that is both evocative and inspirational. GWWO works with public and private clients on cultural and educational projects throughout Maryland, the region, and the United States, including K-12, higher education, interpretive center, nature center, museum, theater, arts, library, park, and recreation facilities.



Tom Liebel, FAIA, LEED Fellow – Juror

Firm Name: Moseley Architects (Baltimore, MD)

Role in Firm: Vice-President

Tom has been involved in integrating sustainable design principles into a variety of ground-breaking adaptive use and affordable housing projects over the past twenty years, with these projects recognized with multiple awards for design, smart growth, sustainable design and historic preservation.

Elevated to Fellowship to both the AIA and USGBC in 2011, Tom is involved in ongoing research exploring the relationship between sustainability, preservation and urban design, with a particular emphasis in the use of urban adaptive use projects to promote neighborhood revitalization and civic engagement. Tom served two terms as Chair the Maryland Green Building Council and chaired Baltimore City’s Commission on Historical and Architectural Preservation for a decade, serves on the Maryland Advisory Council for Historic Preservation, and served as the 2020 Moderator for the American Institute of Architect’s Strategic Council.



Barbara Sweeney, AIA – Juror

Firm Name: Wiedemann Architects, LLC (Bethesda, MD)

Role in Firm: Associate

Barbara has been a project architect and project manager for numerous award-winning residential designs. After getting a B.S. Arch degree from University of Virginia and a Master of Architecture degree from University of Maryland, she worked at several Baltimore firms before arriving at Wiedemann Architects in Bethesda Maryland 16 years. As a senior associate, she supervises staff as well as leads project design and construction of both new construction and renovation.

She has been involved with the AIA for over 30 years, serving on boards at both the Baltimore and Chesapeake Bay Chapters in Maryland.



American Joe Miedusiewski, Esq. – Juror

Firm Name: Old Line Government Affairs, LLC (Annapolis, MD)

Role in Firm: Senior Government Affairs Director

Mr. Miedusiewski served in the Maryland House of Delegates from 1975-1988, the Maryland State Senate from 1988-1995 and was a candidate for Governor in Maryland’s 1994 Primary Election. He has been a lobbyist representing the private sector for 23 years. His background as a legislator, business owner and lobbyist provides clients the depth and breadth of access and experience they expect. Prior to joining Old Line Government Affairs, he was the chair of the Government Affairs practice with Semmes, Bowen & Semmes in Baltimore. Mr. Miedusiewski is also a speaker, seminar leader, and trainer on state government lobbying to national and local clients. He is a graduate of University of Baltimore.

RESIDENTIAL PROJECTS



Project: **Pilot Point**
Architect: **SEA Studio Architects**

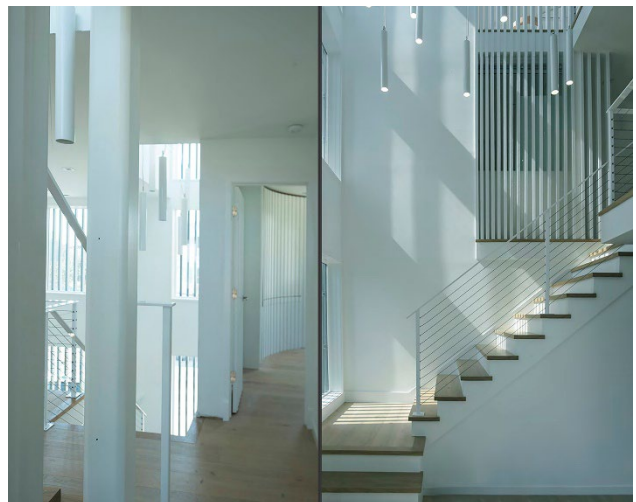

Project: **Ocean Sundial**
Architect: **Donald Lococo Architects**



Project: **Ocean of Dreams**
Architect: **Bernardon**



Project: **Lakefront Home**
Architect: **Wiedemann Architects LLC**

RESIDENTIAL PROJECTS



Project: **House on White Creek**
Architect: **SEA Studio Architects**



Project: **Bay View House**
Architect: **Davis, Bowen & Friedel, Inc.**
Collaborating Architect: **Susan C. Wigley Architect**



Project: **202 Wellington**
Architect: **SEA Studio Architects**



Project: **110 4th Street**
Architect: **SEA Studio Architects**

NON-RESIDENTIAL PROJECTS

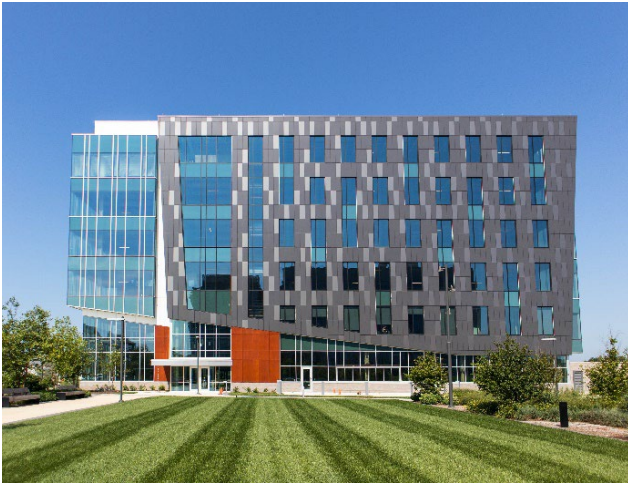

Project: **The FinTech Building**
Architect: **Bernardon**



Project: **River Park Center**
Architect: **Davis, Bowen & Friedel, Inc.**



Project: **Rehoboth Beach City Hall**
Architect: **Davis, Bowen & Friedel, Inc.**



Project: **Lovett Workplace-From Space to a Place**
Architect: **Clark Design Group pc**

NON-RESIDENTIAL PROJECTS



Project: **Fintech Headquarters**
Architect: **Tevebaugh Architecture**



Project: **Fairview Campus Performing Arts Center**
Architect: **ABHA Architects**



Project: **Botanic Bathrooms**
Architect: **SEA Studio Architects**



Project: **Abessinio Stadium Reconstruction**
Architect: **ABHA Architects**

HISTORIC RESOURCES PROJECTS



Project: **Village of St. John**
Architect: **Architectural Alliance, Inc.**



Project: **Uptown! Knauer Performing Arts Center**
Architect: **Homsey Studio**
at **Tevebaugh Architecture**



Project: **University of Delaware**
Wellbeing Center at Warner Hall
Architect: **ABHA Architects**
Collaborating Architect:
Robert A.M. Stern Architects (RAMSA)



Project: **David House Restoration**
Architect: **SEA Studio Architects**

UNBUILT PROJECTS



Project: **Food Bank of Delaware**
Architect: **Becker Morgan Group**

THANK YOU TO OUR PROGRAM SPONSORS

Program Sponsor



Cocktail Hour Sponsor



Sponsor





AIA Contract Documents



Real projects start with the industry standard



Before they broke ground, HBG Design ensured the **Guest House at Graceland™ Resort** was protected with AIA contracts.

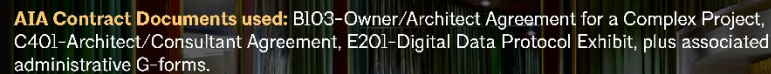

AIA Contract Documents used: B103-Owner/Architect Agreement for a Complex Project, C401-Architect/Consultant Agreement, E201-Digital Data Protocol Exhibit, plus associated administrative G-forms.

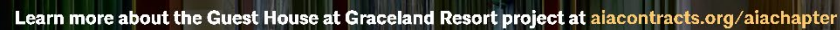

Learn more about the Guest House at Graceland Resort project at aiacontracts.org/aiachapter



Photography ©Jeffrey Jacobs



 **AIA** Document B103
Standard Form of Agreement Between Owner and
Project

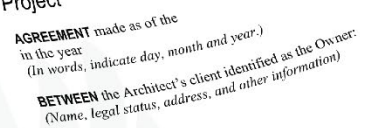

AGREEMENT made as of the _____ day of _____
in the year _____
(In words, indicate day, month and year.)
BETWEEN the Architect's client identified as the Owner:
(Name, legal status, address, and other information)

THANK YOU TO OUR PARTNERS



**VANDEMARK
& LYNCH, INC.**
ENGINEERS • PLANNERS • SURVEYORS



TIGHE & COTTRELL, P.A.

One Customs House
704 King Street, Suite 500
P. O. Box 1031
Wilmington, DE 19899
(302) 658-6400

**LEGAL CONSULTANTS TO THE DESIGN PROFESSIONAL IN
DELAWARE, NEW JERSEY, MARYLAND AND PENNSYLVANIA**

Licensure, Business Formation, Ownership Transition,
Labor and Employment, Contract Negotiation and Risk Management,
Collections, Litigation and Professional Liability Defense

Branch Offices:
Woodstown, NJ Philadelphia, PA Towson, MD

Contact: Paul Cottrell - P.Cottrell@tighecottrell.com
Contact: Melissa Rhoads - M.Rhoads@tighecottrell.com
Contact: Patrick McGrory - P.McGrory@tighecottrell.com



PRINTING & GRAPHICS

PRINTING SINCE 1959

298 Churchmans Road
New Castle, DE 19720
www.rciplot.com

302.328.5019 p
302.328.5067 f

CONSTRUCTION DOCUMENT SPECIALISTS

